



AKSİYAL DUMAN TAHLİYE FANLARI

axial smoke exhaust fans



GENEL AÇIKLAMA

- Yüksek dayanıklı malzemeden imal edilmiştir.
- Alüminyum / plastik pervane **alternatif**
- Duvar, kanal, çatı tipi **alternatif**
- EN 12101-3 uygunserti kalı
- 200°C/2 saat - 300°C/1 saat - 400°C 2 saat
- 120°C sürekli Dayanımlı **alternatif**
- Çift yönlü çalışma özelliği
- Çift devirli-frekans invertörü ile kullanılmaya uygun
- Dış ortamda çalışmaya uygun

GENERAL DESCRIPTION

- Made of high resistance material
- Aluminum / plastic impellers
- Wall, duct, roof types
- EN 12101-3 certified, coated
- 200° C/2h - 300°C/1h -400°C2h
- Suitable for continuously 120°C
- Reversible
- Suitable to use double speed / with frequency inverter
- Suitable to use in outdoor applications

TEKNİK ÇİZİM | TECHNICAL DRAWING

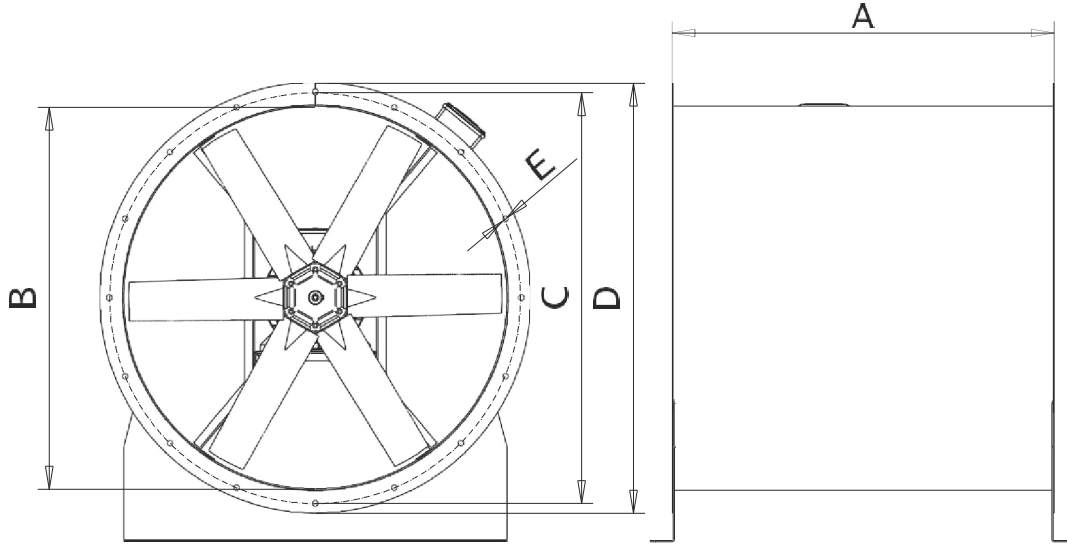

TEKNİK ÖLÇÜLER | TECHNICAL DIMENSIONS

Tüm Ölçüler mm'dir. | All dimensions are in mm

Tip / Type	A	B	C	D	E	DELİK SAYISI
GDEF 400-5-25	330	Ø400	430	460	9	8
GDEF 450-5-25	330	Ø450	430	510	9	8
GDEF 500-5-25	430	Ø500	530	560	9	8
GDEF 560-5-25	430	Ø560	580	620	9	12
GDEF 630-5-30	430	Ø630	660	690	9	12
GDEF 710-5-30	430	Ø710	750	790	9	12
GDEF 800-5-30/35	430	Ø800	840	880	9	16
GDEF 900-5/8-35/40	430	Ø900	940	980	9	16
GDEF 1000-8-40/45	530	Ø1000	1040	1080	9	16
GDEF 1120-8-40/45	530	Ø1120	1060	1200	9	16

TEKNİK VERİLER | TECHNICAL DATA

Tip / Type	GDEF400 5-25	GDEF450 5-25	GDEF500 5-25	GDEF560 5-25	GDEF630 5-30	GDEF710 5-30
Gerilim / Volt	380	380	380	380	380	380
Frekans / Hz	50	50	50	50	50	50
Güç / Kw	0,37	0,55	0,55	0,75	1,1	1,5
Debi m³/h	3000	4400	6000	8200	14000	20000
Devir / d-dak	1400	1400	1400	1400	1400	1400

Tip / Type	GDEF800 5-30	GDEF800 5-35	GDEF900 5-35	GDEF900 5-40	GDEF900 8-40
Gerilim / Volt	380	380	380	380	380
Frekans / Hz	50	50	50	50	50
Güç / Kw	2,2	3	4	5,5	11
Debi m³/h	26000	32000	40000	48000	49000
Devir / d-dak	1400	1400	1400	1400	1400

Tip / Type	GDEF1000 5-40	GDEF1000 8-40	GDEF1000 8-45	GDEF1120 8-40	GDEF1120 8-45
Gerilim / Volt	380	380	380	380	380
Frekans / Hz	50	50	50	50	50
Güç / Kw	7,5	15	18,5	22	30
Debi m³/h	56000	65000	73000	90000	100000
Devir / d-dak	1400	1400	1400	1400	1400

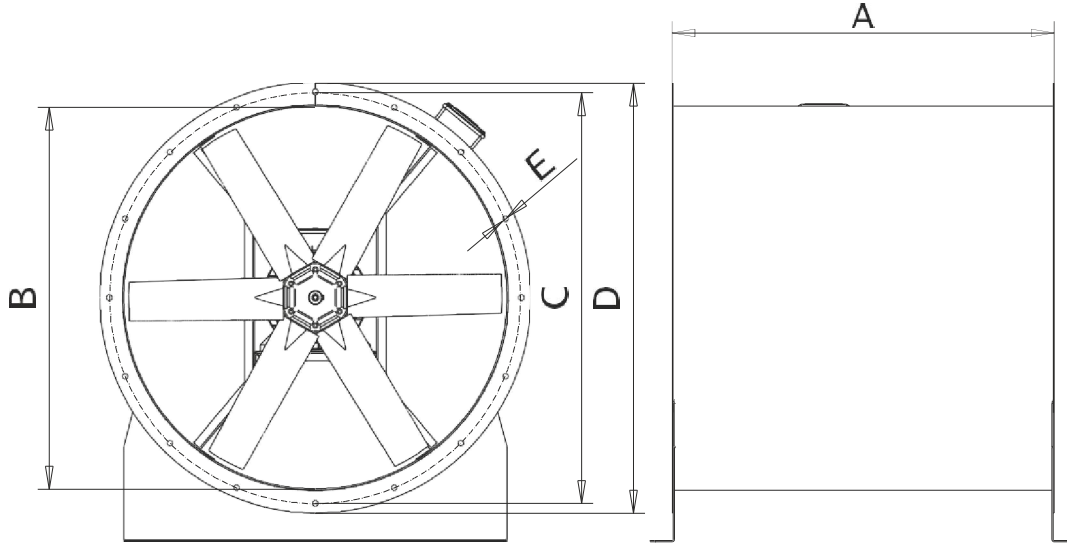

TEKNİK ÖLÇÜLER | TECHNICAL DIMENSIONS

Tüm Ölçüler mm'dir. | All dimensions are in mm

Tip / Type	A	B	C	D	E	DELİK SAYISI
GBF 400-5-25	330	Ø400	430	460	9	8
GBF 450-5-25	330	Ø450	430	510	9	8
GBF 500-5-25	430	Ø500	530	560	9	8
GBF 560-5-25	430	Ø560	580	620	9	12
GBF 630-5-30	430	Ø630	660	690	9	12
GBF 710-5-30	430	Ø710	750	790	9	12
GBF 800-5-30/35	430	Ø800	840	880	9	16
GBF 900-5/8-35/40	430	Ø900	940	980	9	16
GBF 1000-8-40/45	530	Ø1000	1040	1080	9	16
GBF 1120-8-40/45	530	Ø1120	1060	1200	9	16

TEKNİK VERİLER | TECHNICAL DATA

Tip / Type	GBF400 5-25	GBF450 5-25	GBF500 5-25	GBF560 5-25	GBF630 5-30	GBF710 5-30
Gerilim / Volt	380	380	380	380	380	380
Frekans / Hz	50	50	50	50	50	50
Güç / Kw	0,37	0,55	0,55	0,75	1,1	1,5
Debi m³/h	3000	4400	6000	8200	14000	20000
Devir / d-dak	1400	1400	1400	1400	1400	1400

Tip / Type	GBF800 5-30	GBF800 5-35	GBF900 5-35	GBF900 5-40	GBF900 8-40
Gerilim / Volt	380	380	380	380	380
Frekans / Hz	50	50	50	50	50
Güç / Kw	2,2	3	4	5,5	11
Debi m³/h	26000	32000	40000	48000	49000
Devir / d-dak	1400	1400	1400	1400	1400

Tip / Type	GBF1000 5-40	GBF1000 8-40	GBF1000 8-45	GBF1120 8-40	GBF1120 8-45
Gerilim / Volt	380	380	380	380	380
Frekans / Hz	50	50	50	50	50
Güç / Kw	7,5	15	18,5	22	30
Debi m³/h	56000	65000	73000	90000	100000
Devir / d-dak	1400	1400	1400	1400	1400

PERFORMANS VERİLERİ | PERFORMANCE DATA

GBF-400

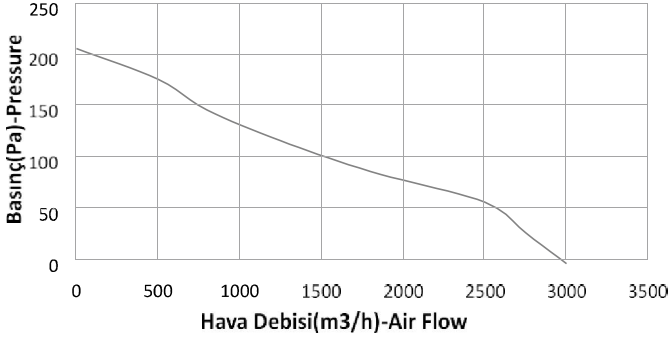

GBF-450

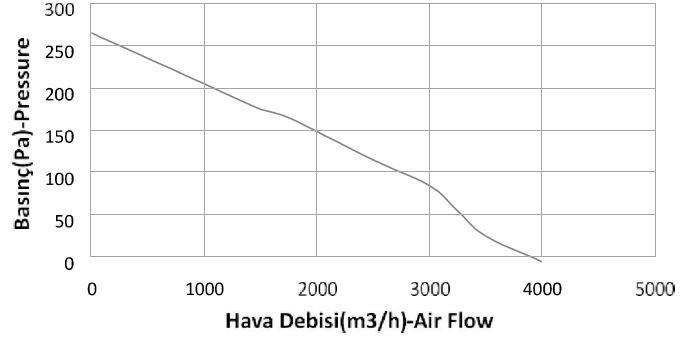

GBF-500

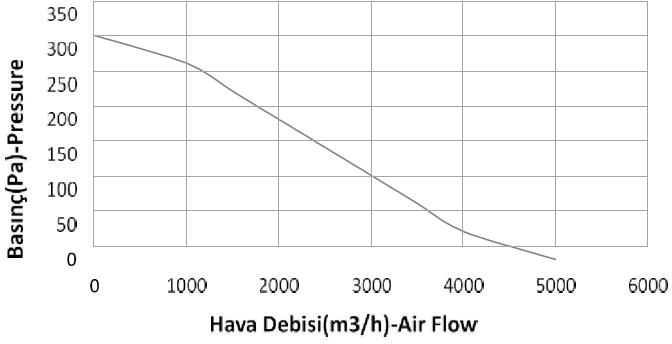

GBF-560

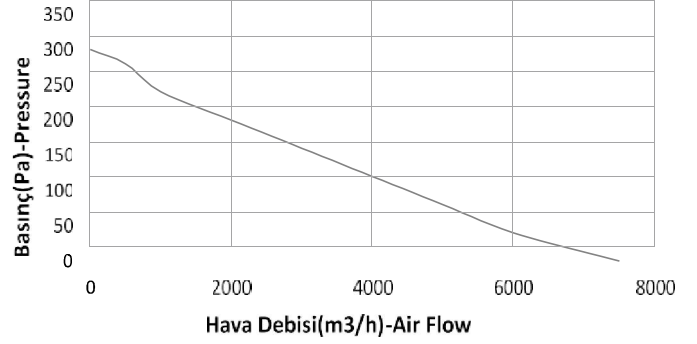

GBF-630

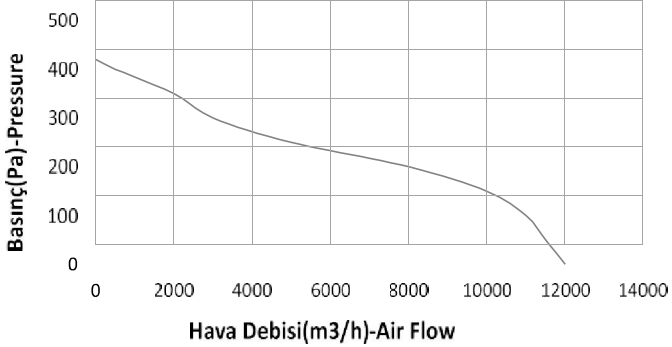

GBF-710

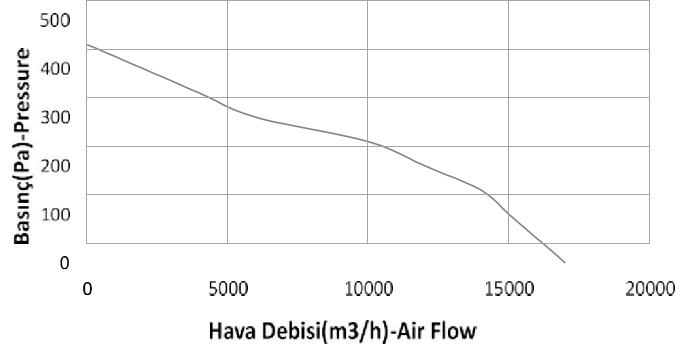

GBF-800 - 2.2 kw

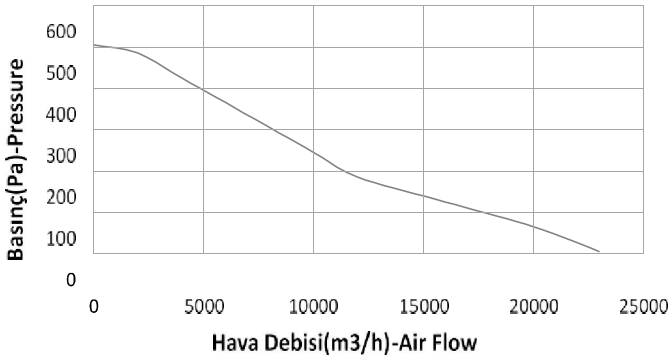

GBF-800 - 3 kw

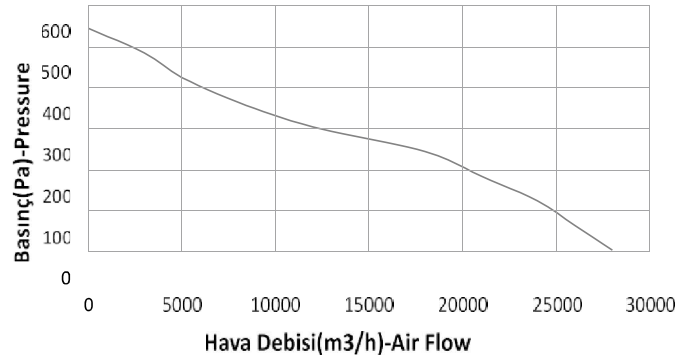

PERFORMANS VERİLERİ | PERFORMANCE DATA

GBF-900 - 4 kw

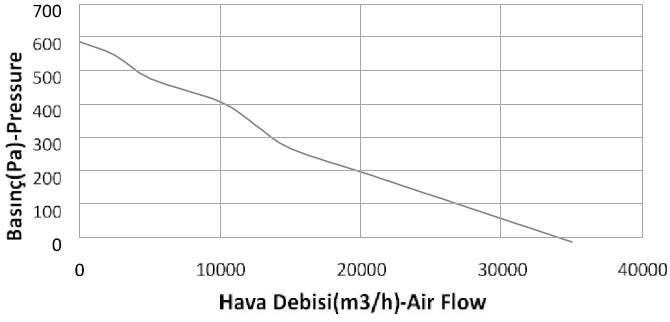

GBF-900 - 5.5 kw

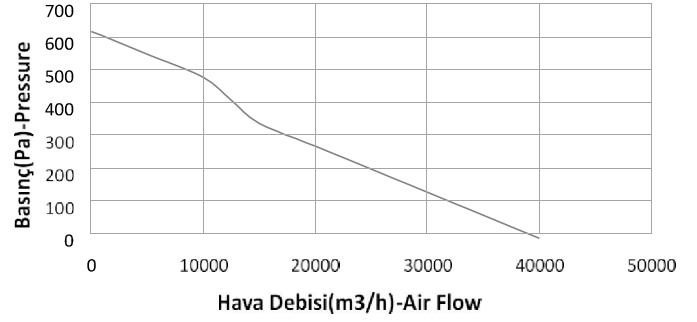

GBF-900 - 11 kw

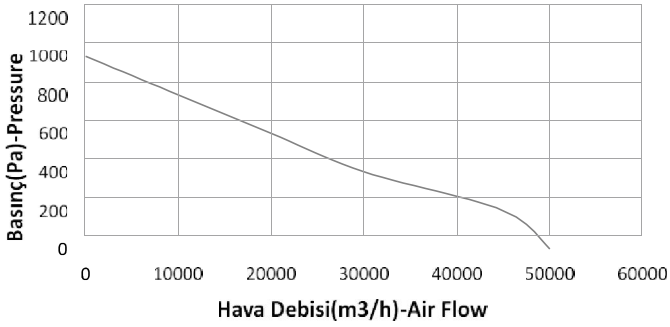

GBF-1000 - 7.5 kw

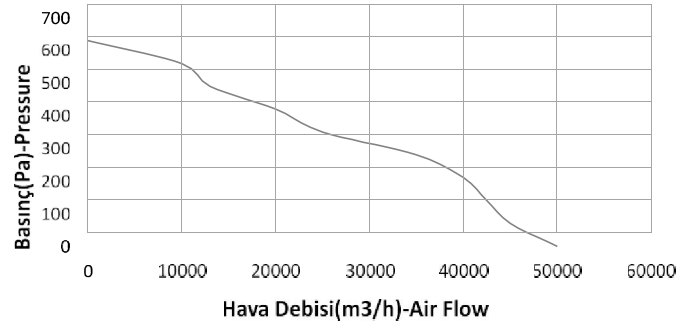

GBF-1000 - 15 kw

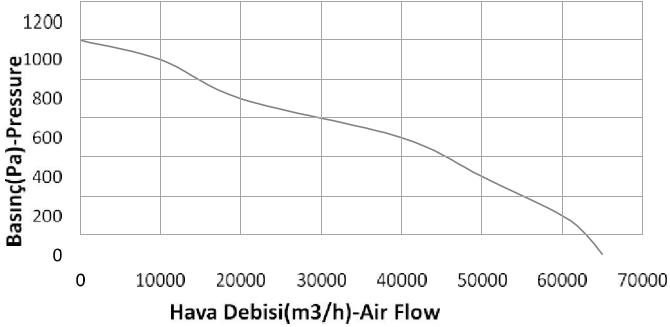

GBF-1000 - 18.5 kw

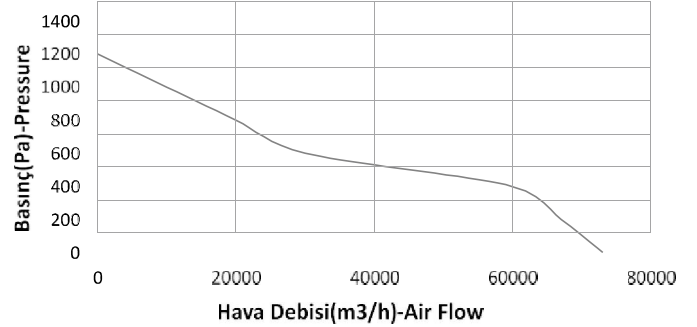

GBF1120 - 22

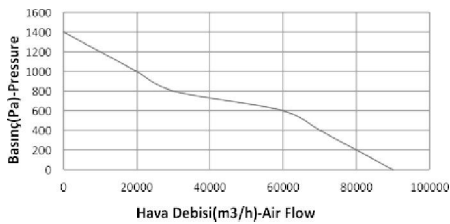

GBF1120 - 30

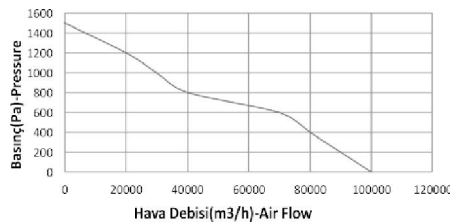

GBF-1120 - 37

